

KEYED NOTES		
MARK	QTY	DESCRIPTION
1	1	SKID-RESISTANT STEEL PEDESTRIAN DUTY STD. [TRAFFIC-DUTY OPTIONAL]
2	1	CAST-IN STEEL FRAME
3	1	OPTIONAL EXTENSION 6" OR 12"
4	1	PRECAST CONCRETE BASIN SECTION
5	4	THIN WALL KNOCKOUT ON ALL 4 SIDES, SEE KO DIMENSION FOR MAXIMUM PIPE O.D.
6	1	NAMEPLATE INDICATING: MFG: PARKUSA 888-611-PARK WWW.PARKUSA.COM MODEL: JB-01 DATE MANUFACTURED
7	-	ALL JOINTS SEALED WATER-TIGHT WITH RAM-NEK

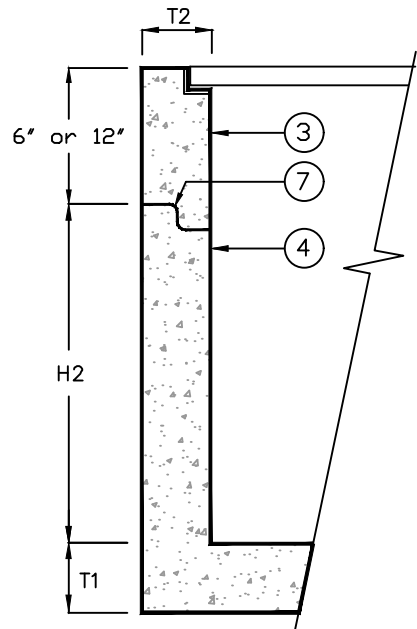

PARTIAL SECTION

© ParkUSA. ALL RIGHTS RESERVED.

MODEL	W1	W2	H1	H2	T1	T2	KO	COVER SIZE	WEIGHT LBS
JB-12	15"	10"	21"	18"	3"	2 1/2"	10"	12"x12"x1"	180
JB-14	20"	14"	28"	24"	4"	3"	12"	14"x14"x1 1/2"	600
JB-18	24"	16"	34"	30"	4"	4"	15"	18"x18"x1 1/2"	1,000
JB-20	26"	18"	34"	30"	4"	4"	17"	20"x20"x1 1/2"	1,335
JB-24	32"	22"	41"	36"	5"	5"	22"	24"x24"x2"	2,245
JB-27	37"	25"	42"	36"	6"	6"	24"	27"x27"x2"	2,875
JB-30	42"	30"	42"	36"	6"	6"	30"	32"x32"x2"	3,675
JB-36	48"	36"	42"	36"	6"	6"	32"	38"x38"x2"	4,585
JB-48	60"	48"	54"	48"	6"	6"	48"	38"x38"x2"	7,250

SPECIFICATIONS

- CONCRETE: CLASS I/II CONCRETE WITH OF DESIGN STRENGTH OF 4500 PSI AT 28 DAYS. UNIT IS OF MONOLITHIC CONSTRUCTION AT FLOOR AND FIRST STAGE OF WALL WITH SECTIONAL RISER TO REQUIRED DEPTH.
- REINFORCEMENT: GRADE 60 REINFORCED. STEEL REBAR CONFORMING TO ASTM A615 ON REQUIRED CENTERS OR EQUAL.
- COVER & FRAME: ALL STEEL FABRICATION SHALL BE IN ACCORDANCE TO AWA D1.1. STEEL SHALL BE ASTM A36 CARBON STEEL, AND HOT-DIPPED GALVANIZED AFTER FABRICATION IN ACCORDANCE TO ASTM A123



JUNCTION BOX					REV.
MODEL JB - 12" THRU 48"					A
PM	PC	DRN	ENG	DWG. NO.	
DATE	2023			JB-1	

PLOTTED ON 12/15/2023 3:45 PM BY Howerton, Chris Y. Paridega Website 2023 - NEED TO GO UTILITY FOLDER JB-01-2023