

③

X
SET-1
XXXXXX
XX/XX

NAME PLATE

KEYED NOTES		
MARK	QTY	DESCRIPTION
1	1	PRECAST CONCRETE SAFETY END TREATMENT
2	1	HOLE FOR PIPE (BY OTHERS)
3	1	NAMEPLATE INDICATING: MFG: ParkUSA 888-611-PARK MODEL: SET-1 DATE MANUFACTURED

MODEL	D	SLOPE	W	L	T	E	WEIGHT
SET123	12"	3:1	1'-10"	3'-3"	5"	12"	1,680
SET124	12"	4:1	1'-10"	4'-4"	5"	12"	2,040
SET126	12"	6:1	1'-10"	8'-0"	5"	12"	2,760
SET153	15"	3:1	2'-1 1/4"	4'-0"	5"	12"	1,680
SET154	15"	4:1	2'-1 1/4"	5'-4"	5"	12"	2,040
SET156	15"	6:1	2'-1 1/4"	8'-0"	5"	12"	2,760
SET183	18"	3:1	2'-5 1/4"	4'-9"	5"	12"	2,120
SET184	18"	4:1	2'-5 1/4"	6'-4"	5"	12"	2,600
SET186	18"	6:1	2'-5 1/4"	9'-6"	5"	12"	3,560
SET243	24"	3:1	2'-11 1/2"	6'-3"	5"	12"	3,120
SET244	24"	4:1	2'-11 1/2"	8'-4"	5"	12"	3,880
SET246	24"	6:1	2'-11 1/2"	12'-6"	5"	12"	5,400
SET303	30"	3:1	3'-5 1/4"	7'-9"	5"	12"	4,280
SET304	30"	4:1	3'-5 1/4"	10'-4"	5"	12"	5,400
SET306	30"	6:1	3'-5 1/4"	15'-6"	5"	12"	7,600
SET363	36"	3:1	4'-3"	10'-0"	6"	12"	6,200
SET364	36"	4:1	4'-3"	12'-0"	6"	12"	9,040
SET366	36"	6:1	4'-3"	18'-3"	6"	12"	13,000

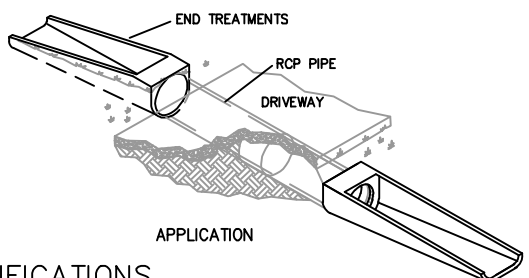
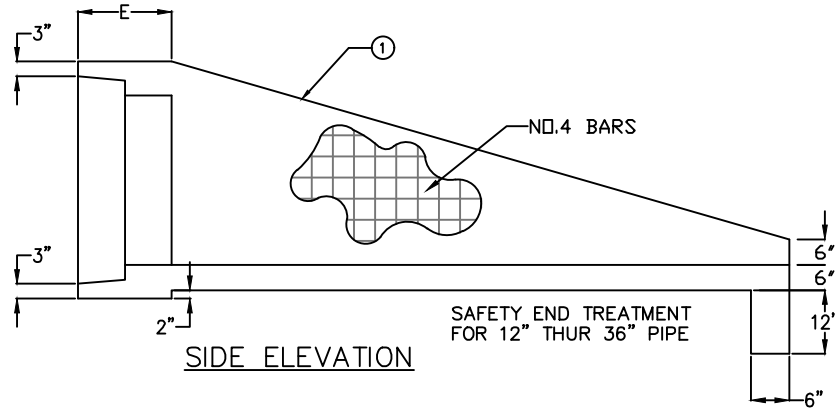

SPECIFICATIONS

CONCRETE: Class I/II concrete with of design strength of 4500 PSI at 28 days. Unit is of monolithic construction including walls & floor.

REINFORCEMENT: Grade 60 reinforced. No. 4 steel rebar to conform to ASTM A615 on required centers or equal.

- NOTES:**
- CLASS "C" CONCRETE
 - 12" ARE MADE WITH 12" KNOCK OUT FOR SMALLER PIPE IN 15" SET MOLD
 - 6" WALL IN 36" AS PER CHART
 - REINFORCEMENT:
12"-24" #4 BARS @ 9" % GRADE 60
24"-36" #4 BARS @ 6" % GRADE 60

